

Sizes Available For Two Hole Cable Cleats On Trefoil Configuration / Three Cable.

Cat. No.	Cable Dia.	Std. Pack	Dimensions					
			A	B	C	D	E	F
TF3033	33	12	158	74	60	126	11	16.5
TF3036	36	12	158	80	60	126	11	18.0
TF3039	39	12	158	87	60	126	11	19.5
TF3042	42	12	170	94	60	138	11	21.0
TF3044	44	12	170	97	60	138	11	22.0
TF3047	47	12	180	100	60	148	11	23.5
TF3050	50	12	180	106	60	148	11	25.0
TF3053	53	12	200	110	60	164	11	26.5
TF3055	55	12	200	115	60	164	11	27.5
TF3057	57	6	222	119	70	183	13	28.5
TF3060	60	6	222	128	70	183	13	30.0
TF3063	63	6	222	133	70	183	13	31.5
TF3067	67	6	243	140	70	204	13	33.5
TF3070	70	6	243	148	70	204	13	35.0
TF3084	84	6	278	170	80	239	13	42.0
TF3087	87	6	278	175	80	239	13	43.5
TF3090	90	6	278	180	80	239	13	45.0
TF3093	93	6	330	190	90	276	13	46.5
TF3095	95	6	330	196	90	276	13	47.5
TF3100	100	6	330	215	90	276	13	50.0
TF3120	120	6	400	240	100	338	14	60.0
TF3134	134	6	400	260	100	338	14	67.0

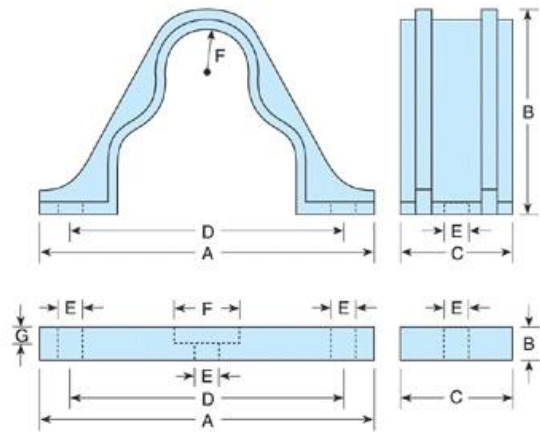

Sizes Available For Two Hole Cable Cleats On Optional Base.

Cat. No.	Dimensions						
	A	B	C	D	E	F	G
BTF3033, 3036, 3039	158	25	60	126	11	24	10
BTF3042, 3044	170	25	60	138	11	24	10
BTF3047, 3050	180	25	60	148	11	24	10
BTF3053, 3055	200	25	60	164	11	24	10
BTF3057, 3060, 3063	222	25	70	183	13	41	12.5
BTF3067, 3070	243	25	70	204	13	41	12.5
BTF3084, 3087, 3090	278	25	80	239	13	41	12.5
BTF3093, 3095, 3100	330	25	90	276	13	41	12.5
BTF3120, 3134	400	25	100	338	13	41	12.5